



# FLOORPLANS

SPECIALIZING IN MOBILE & MODULAR BUILDING SOLUTIONS

## STANDARD 8 WIDES:

### 8 x 20 Office

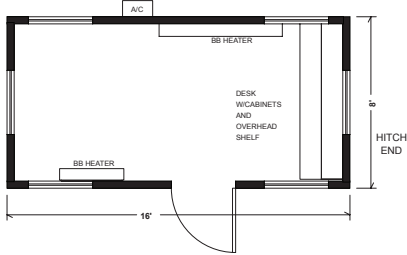

### 8 x 24 Office

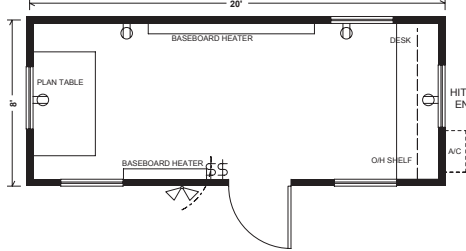

### 8 x 30 Office

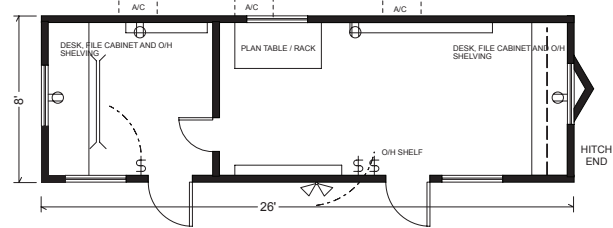

### 8 x 30 Office/Storage Combo

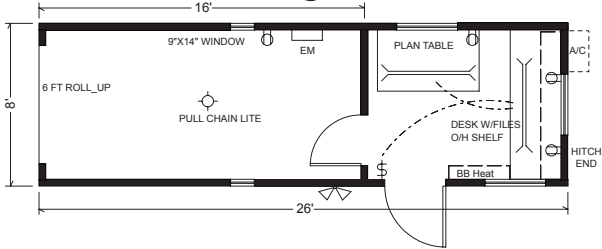

### 8 x 36 Office/Storage Combo

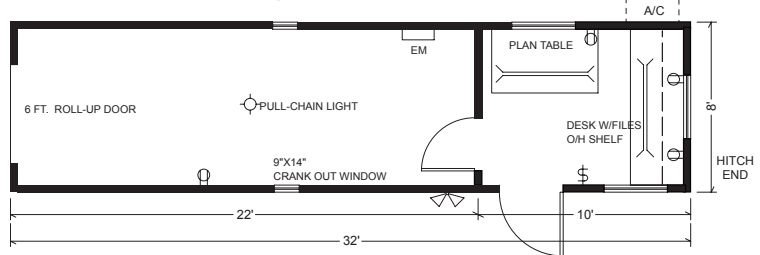

## STANDARD 10 WIDES:

### 10 x 36 Office

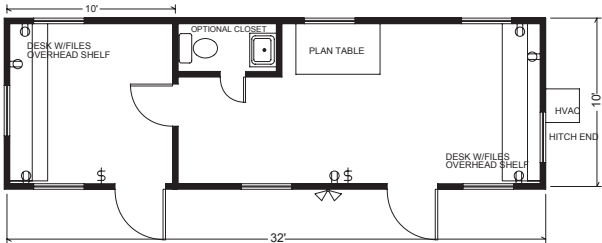

### 10 x 44 Office

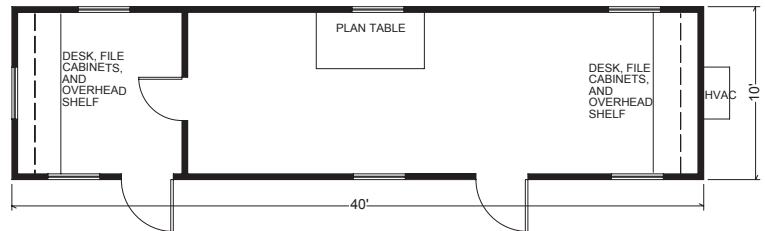

### 10 x 50 Office

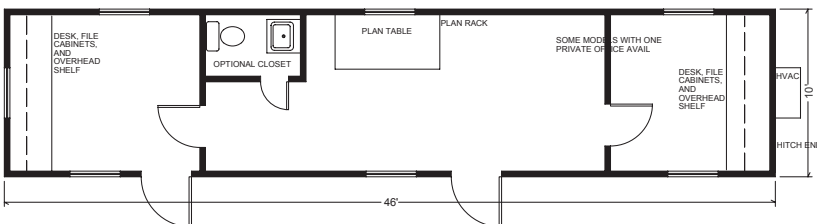

SERVING INDIANA FOR OVER 35 YEARS

Our Sales Team can be reached at:

**800.538.2597**

[www.tysoncorporation.com](http://www.tysoncorporation.com)

**Quality Buildings • Quality Services • Quality People**

**INDIANA • ILLINOIS • MISSOURI • KENTUCKY**



# PURCHASE • RENT • LEASE

MOBILE OFFICES • MODULAR BUILDINGS • ON-SITE STORAGE

## STANDARD 12 WIDES:

12 x 50 Office

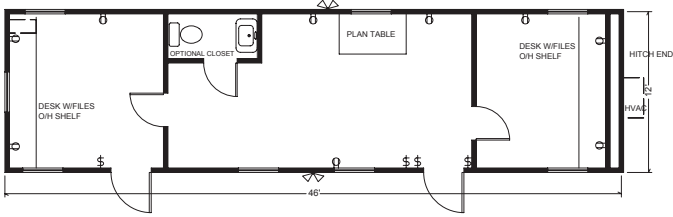

12 x 60 Office

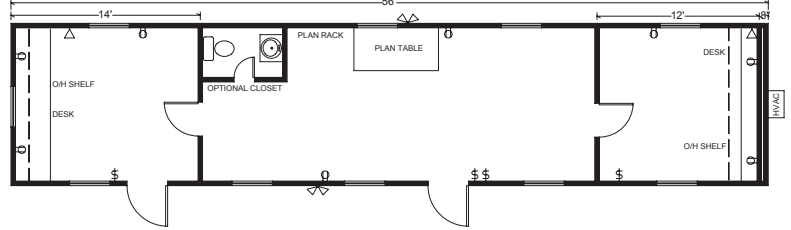

## STANDARD DOUBLEWIDES:

24 x 60 Office

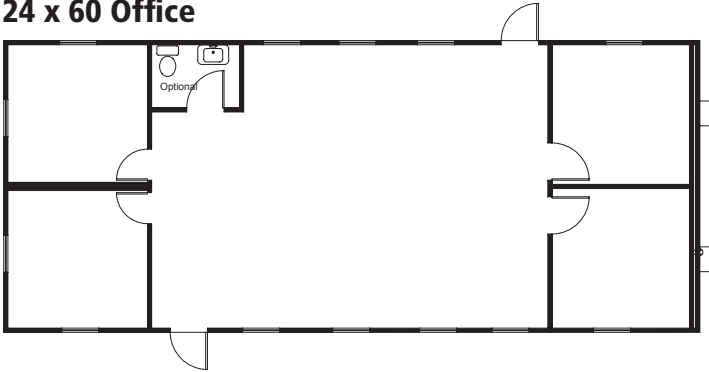

## CLASSROOMS:

24 x 44 Office

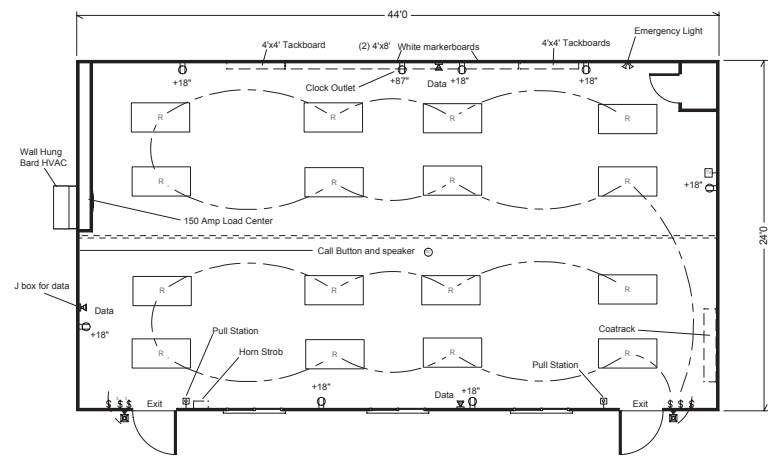

## SALES OFFICES:

12 x 44 Sales Office

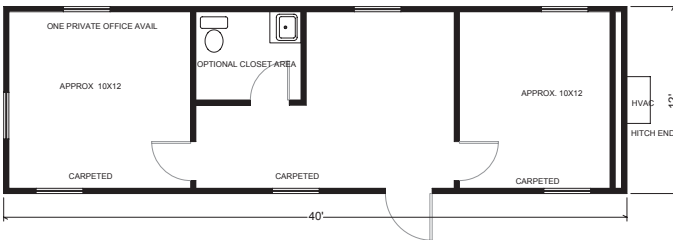

24 x 54 Sales Office

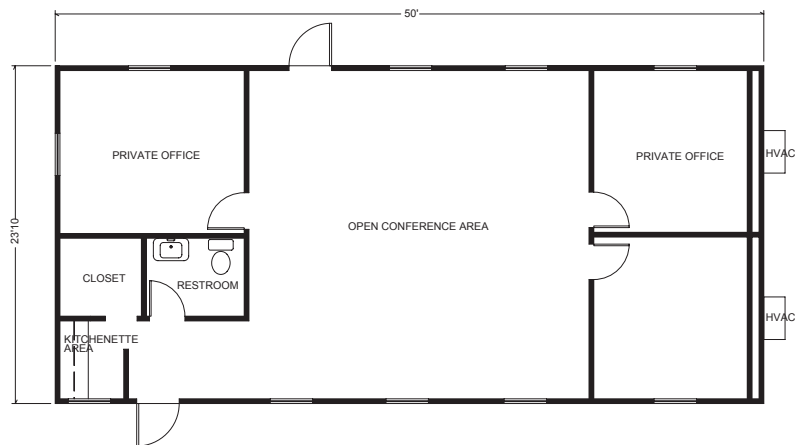

**800.538.2597**

[www.tysoncorporation.com](http://www.tysoncorporation.com)

**Whether you need temporary or permanent space, call Tyson!**